

# CONFERENCE RETREATS AT BANNISTERS PORT STEPHENS







## BANNISTERS PORT STEPHENS

Bannisters Port Stephens is a contemporary coastal hideaway only 2.5 hours' drive north of Sydney and 20 minutes from Newcastle airport.

We are located in Soldiers Point, with mesmerising views of Nelson Bay. Renovated extensively in 2018, our flexible spaces exude modern Australian design with a subtle nod to Palm Springs. We have 78 rooms and suites, with paperbark garden views on the south side of the property and panning bay vistas in our eastern facing rooms and suites.

Conveniently located on the mid-north coast of NSW, our hotel offers a contemporary corporate retreat or conference facilities for you and your team. We can accommodate a range of events from boardroom style to hotel takeovers for up to 150 guests.

If you want to treat the team you cannot go past Spa Bannisters. With an ever-changing seasonal menu, there is a range of treatments to experience for even the most seasoned spa-goer.



ROOM TYPE	AVAILABILITY	CONFIGURATION	MAX/ROOM
Paperbark (garden view)	23 available	1x king bed <b>OR</b> 2x single beds	2 adults
Two Room Paperbark (garden view)	1 available	2x king bed <b>OR</b> 4x single beds	4 adults
Paperbark Family Room (garden view)	5 available	1x king + 1x single <b>OR</b> 3x single	3 adults
Ocean Deck Rooms Lower Level (Bay view)	22 available (2x pet friendly)	1x king bed <b>OR</b> 2x single beds	2 adults
Ocean Deck Rooms Upper Level (Bay view)	19 available	1x king bed <b>OR</b> 2x single beds	2 adults
Studio Room	3 available (1x no balcony)	1x king bed <b>OR</b> 2x single beds	2 adults
Luxury Suite	4 available (1x pet friendly)	1x king bed	2 adults
Penthouse	1 available	1x king bed	2 adults
Penthouse + 3 Interconnecting	1 available	1x king bed <b>OR</b> 3 x split kings	8 adults

# CONFERENCE FACILITIES

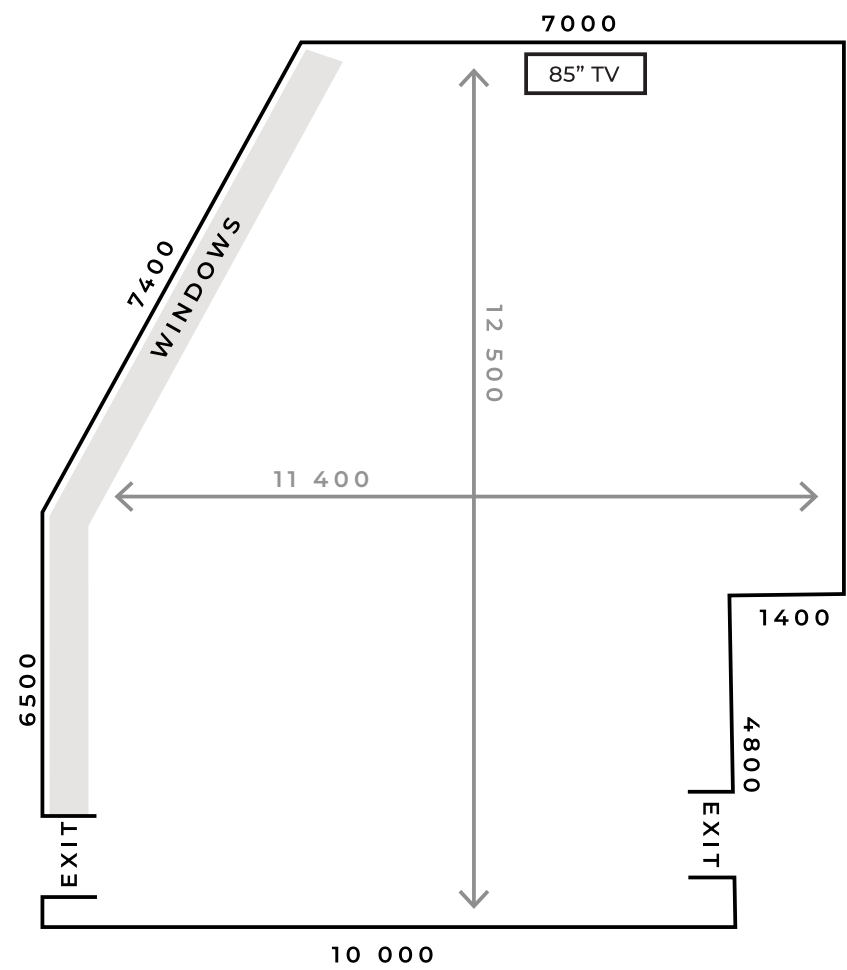

AV	85" screen
WIFI	Yes
Microphones	Yes
Water Views	No
Capacity : Theatre	80
Capacity : Classroom	40
Capacity : Cocktail	120
Capacity : U-Shape	30
Capacity : Boardroom	20

## INCLUSIONS

- ⌘ All conference packages include;
- ⌘ Stationary suite, including whiteboard and flipchart
- ⌘ Bottled mineral water and mints
- ⌘ Pod coffee machine
- ⌘ High Speed Wi-Fi access to all attendees
- ⌘ Complimentary outdoor parking





## CONFERENCE PACKAGES

### HALF DAY PACKAGE - \$60PP

Grazing lunch in the Cheeky Dog

Morning or afternoon tea

Barista coffee and soft drinks

### FULL DAY PACKAGE - \$75PP

Morning tea

Grazing lunch in the Cheeky Dog

Afternoon tea

Barista coffee and soft drinks

*\*Terms and Conditions apply*



## CHEEKY DOG CONFERENCES

Open and light filled the Cheeky Dog's natural recycled materials and soaring ceilings make for a fresh and inviting conferencing space

With flexible seating plans, in-built sound system and 85" TV, the dynamic space can be reconfigured to suit your requirements.

Full Day \$900



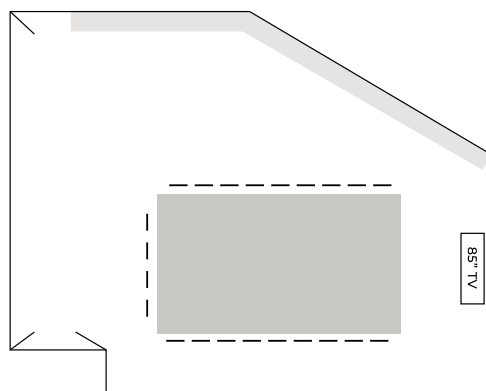

BOARDROOM : 20 PEOPLE

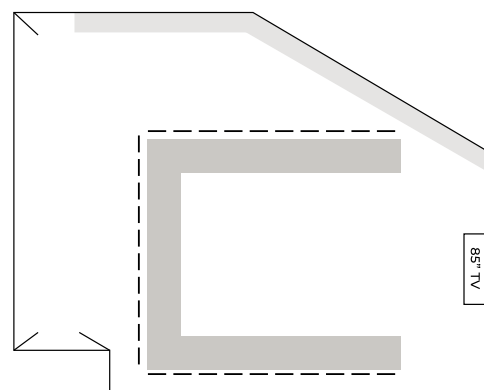

U-SHAPE : 30 PEOPLE

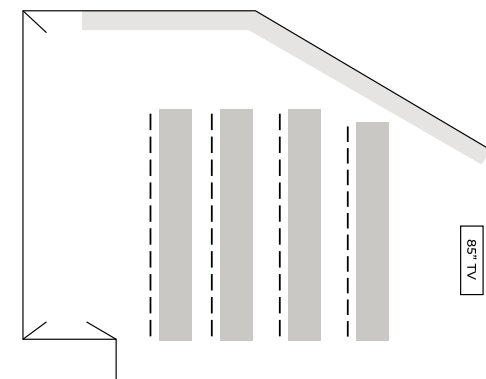

CLASS ROOM : 40 PEOPLE

## CATERING & DINING OPTIONS

The delegate package includes sweet and savoury bites at morning and afternoon tea, as well as a grazing table of sandwiches and wraps and seasonal salads for lunch.

Once you are done for the day, experience our three dining venues. Your conference coordinator will work with our Head Chef Mitchell Turner to organise select menus for your group.

Our onsite dining venues including the iconic Rick Stein at Bannisters. Celebrity chef Rick Stein's seafood restaurant champions the freshest of Port Stephens 'dock to plate' produce and Hunter Valley wines.

Julio's is known for its sweeping views of Port Stephens bay complimented by modern-Mexican bites and cocktails. Our gastro-pub, The Cheeky Dog, serves antipasto and hand-rolled gourmet pizzas in a relaxed and open plan setting.





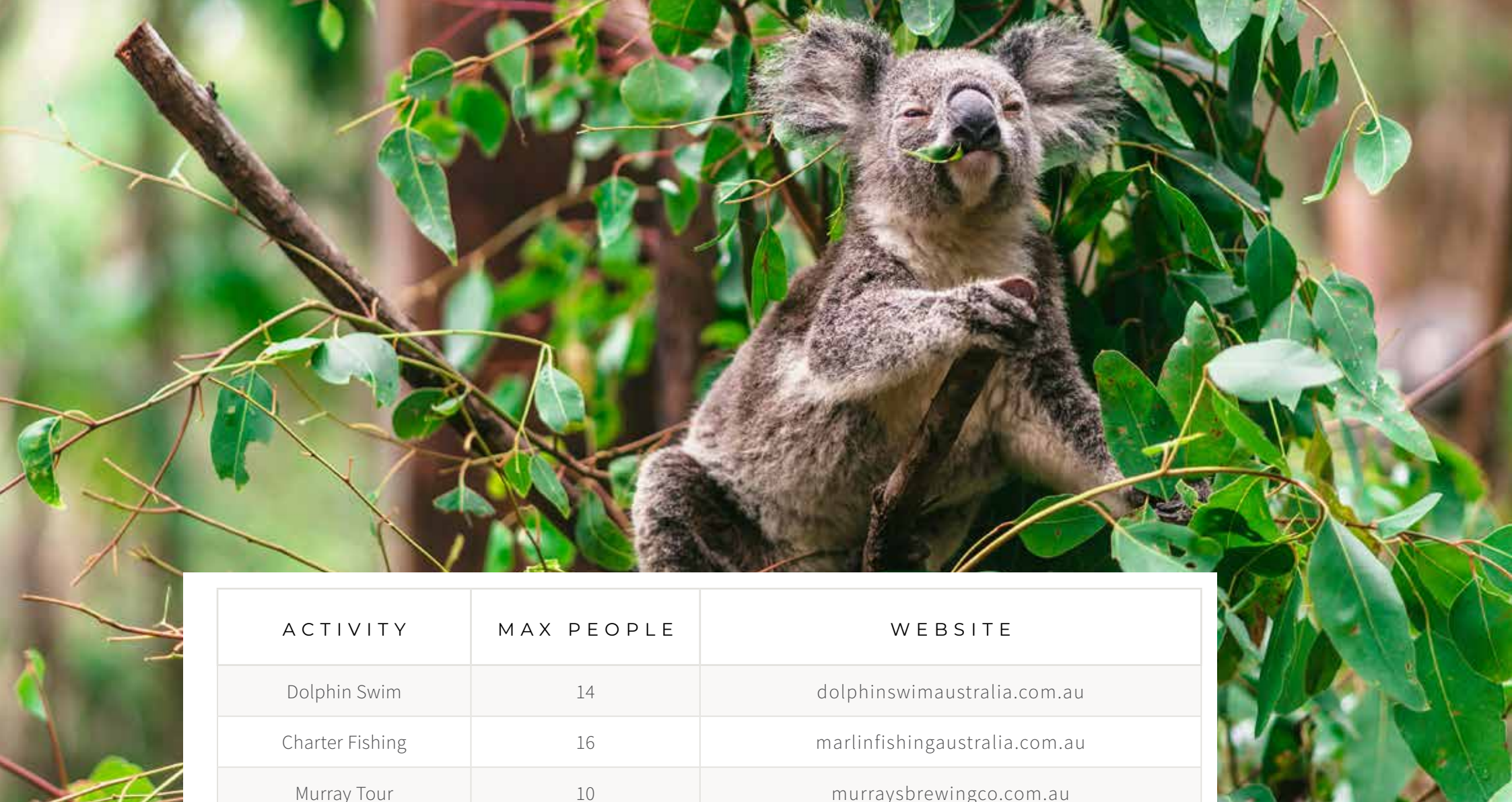

ACTIVITY	MAX PEOPLE	WEBSITE
Dolphin Swim	14	<a href="http://dolphinswimaustralia.com.au">dolphinswimaustralia.com.au</a>
Charter Fishing	16	<a href="http://marlinfishingaustralia.com.au">marlinfishingaustralia.com.au</a>
Murray Tour	10	<a href="http://murraysbrewingco.com.au">murraysbrewingco.com.au</a>
Golf - 18 Holes	20	<a href="http://horizons.com.au">horizons.com.au</a>
2hr Afternoon Sailing	20	<a href="http://bluewatersailing.com.au">bluewatersailing.com.au</a>

A small, partially visible image of a bowl containing a salad or a similar dish, located in the bottom left corner of the page.

## GROUP ACTIVITIES



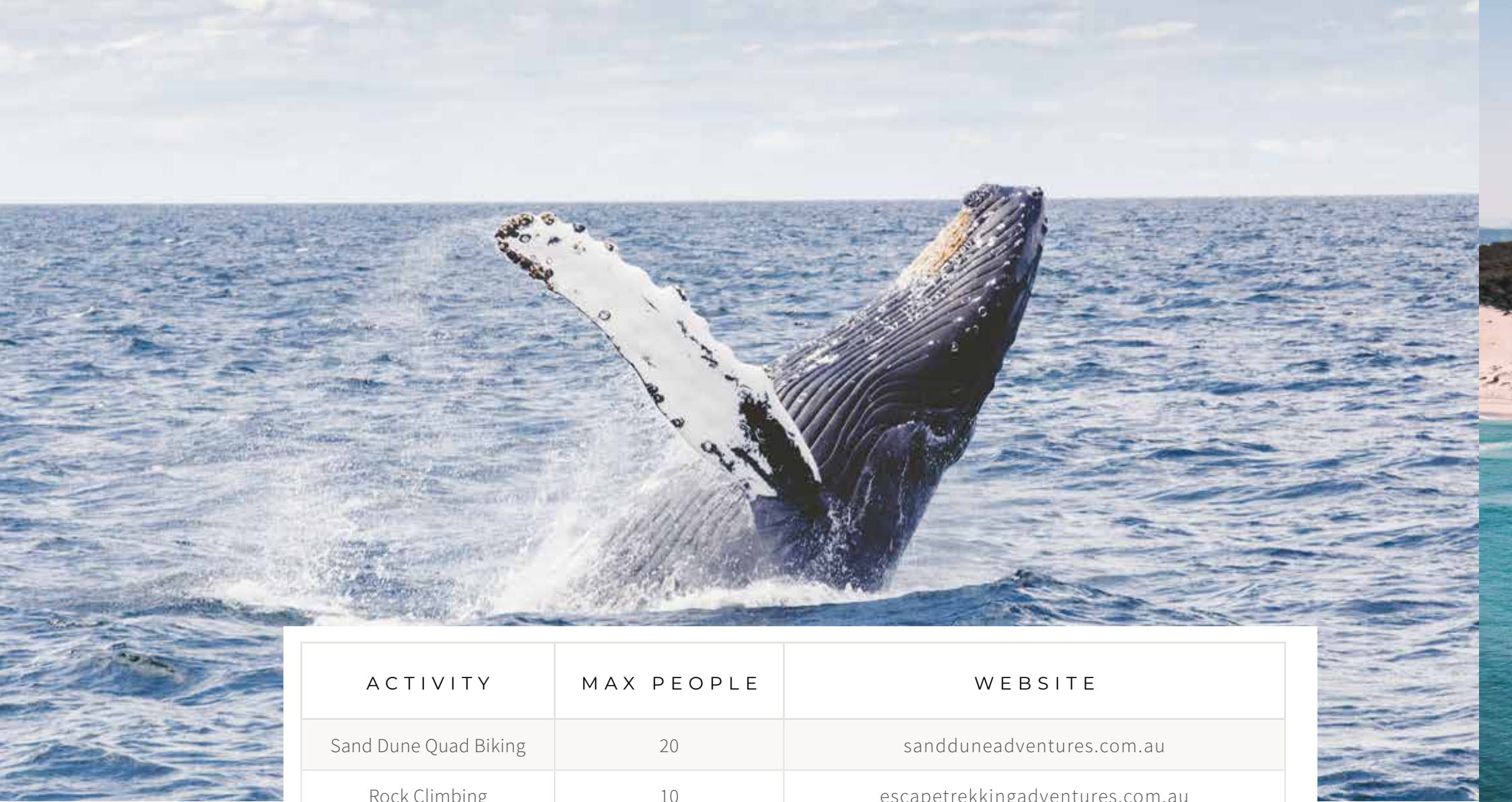

ACTIVITY	MAX PEOPLE	WEBSITE
Sand Dune Quad Biking	20	<a href="http://sandduneadventures.com.au">sandduneadventures.com.au</a>
Rock Climbing	10	<a href="http://escapetrekkingadventures.com.au">escapetrekkingadventures.com.au</a>
Moon Shadow Cruises	200	<a href="http://moonshadow-tqc.com.au">moonshadow-tqc.com.au</a>
Imagine Cruises	60	<a href="http://imaginecruises.com.au">imaginecruises.com.au</a>

TEAM BUILDING ACTIVITIES





# BANNISTERS

port stephens

AnneMaree LaVella | Accommodation Manager

[Annemaree@bannisters.com.au](mailto:Annemaree@bannisters.com.au) | 02 4919 3800

[WWW.BANNISTERS.COM.AU](http://WWW.BANNISTERS.COM.AU)